

FLEX POST[®]

ASSEMBLY GUIDE & PARTS LIST

#	Quantity	Part Number	Dimensions & Description
1	2	37030	1/2" - 13 Lock Nut - Zinc
2	1	RE-SK	Patented Torsion Spring
3	1	RE-#P	Choice of 6' or 8' x 1 5/8" Post - .055" Wall
4	1	RE-BP	9" x 9" Square Base Plate
5	4	33012	1/2" x 1.375" Flat Washer - Zinc
6	2	13824	1/2" - 13 x 3" Tap Bolt - Zinc
7	1	RE-SB	Double Sided Sign Bracket Kit (Includes 2 Sign Brackets, 4 Set Screws, and 4 Lock Nuts)

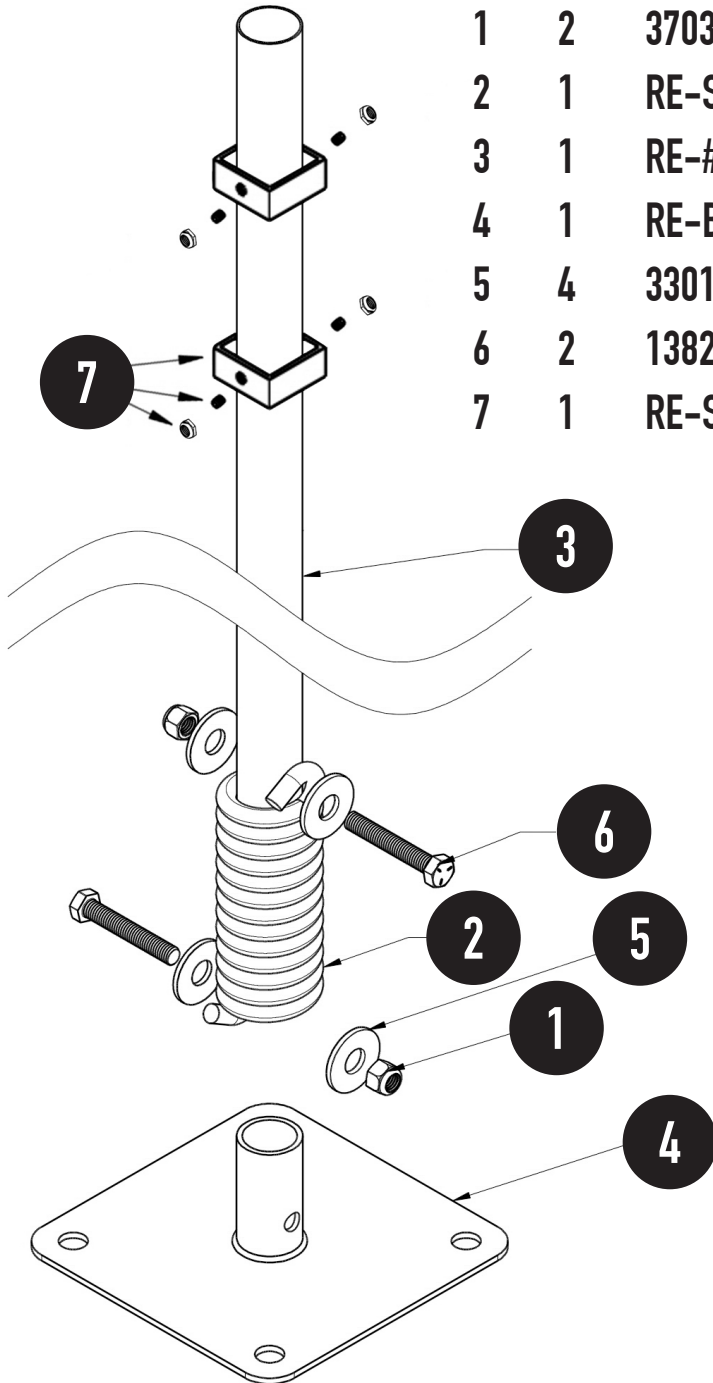

* Sign Sold Separately *

ANCHORING

CHOICE OF:



CONCRETE



ASPHALT



ADHESIVE

REFER TO THE
NEXT PAGE FOR
ANCHORING
INSTRUCTIONS